

This copy is a reprint which includes current pages from Changes 1 and 2.

*TM 11-6625-303-25P

D E P A R T M E N T O F T H E A R M Y T E C H N I C A L M A N U A L

ORGANIZATIONAL, DIRECT SUPPORT, GENERAL SUPPORT,
AND DEPOT MAINTENANCE REPAIR PARTS AND SPECIAL TOOLS LISTS
ELECTRICAL POWER TEST SETS
AN/UPM-93A, AN/UPM-93B, AN/UPM-93C, AND AN/UPM-100

Headquarters, Department of the Army, Washington, D.C.

12 October 1971

Current as of 21 April 1971

		<i>Paragraph Page</i>	
SECTION I.	INTRODUCTION		
	Scope	1-1	1-1
	General	1-2	1-1
	Explanation of columns	1-2	1-1
	Special information	1-4	1-2
	Location of repair parts	1-5	1-3
	Federal supply codes for manufacturers	1-6	1-2
	Reporting of equipment publication improvements	1-7	1-3
	PRESCRIBED LOAD ALLOWANCE (Not applicable)		
II.	REPAIR PARTS FOR ORGANIZATIONAL MAINTENANCE		2-1
	SPECIAL TOOLS TEST AND SUPPORT EQUIPMENT FOR ORGANIZATIONAL MAINTENANCE (Not applicable)		
III.	REPAIR PARTS FOR DIRECT SUPPORT, GENERAL SUPPORT, AND DEPOT MAINTENANCE.		2-1
	SPECIAL TOOLS, TEST AND SUPPORT EQUIPMENT FOR DIRECT SUPPORT, GENERAL SUPPORT, AND DEPOT MAINTENANCE (Not applicable)		
IV.	INDEX-FEDERAL STOCK NUMBER CROSS-REFERENCE TO FIGURE AND ITEM NUMBER OR REFERENCE DESIGNATION		4-1
V.	INDEX-REFERENCE DESIGNATION CROSS-REFERENCE TO PAGE NUMBER		5-1

*This manual supersedes TM 11-6625-303-20P, 13 June 1963, and TM 11-6625-303-45P, 17 July 1963.

CHANGE }
NO. 2 }

HEADQUARTERS
DEPARTMENT OF THE ARMY
WASHINGTON, DC 16 April 1979

**Organizational, Direct Support General Support and
Depot Maintenance Repair Parts and Special Tools List
For
TEST SETS, ELECTRICAL POWER
AN/UPM-100 AND AN/UPM-100A
(NSN 6625-00-542-1290)**

TM 11-6625-303-25P, 12 October 1978, is changed as follows:

Page 4, line item 21, fig No. 7, item No. 7. In the NATIONAL STOCK NUMBER column, change "6625-00-682-4666" to read "6115-00-788-0954."

In the PART NUMBER column, change "6815-125" to read "JHP42-010."

In the FSCM column, change "06339" to read "02032".

Page 6, figure 7. Change item number "7" to read "8."

Change item number "8" to read "7."

Page 7, STOCK NUMBER index. Delete "6625-00-682-4666" in its entirety.

Add the following after stock number "6115-00-745-7591":

STOCK NUMBER	FIG. NO.	ITEM NO.
6115-00-788-0954	7	7

PART NUMBER index. Add above the first line:

PART NUMBER	FSCM	FIG. NO.	ITEM NO.
JHP42-010	02032	7	7

By Order of the Secretary of the Army:

BERNARD W. ROGERS
General, United States Army
Chief of Staff

Official:

J. C. PENNINGTON
Major General, United States Army
The Adjutant General

DISTRIBUTION

Active Army:

USAINSCOM (2)	Units org under fol TOE	29-37
COE (1)	(1 cy each unit UNOINDC)	29-41
TSG (1)	29-207 (2)	29-51
USAARENBD (1)	29-610 (2)	22-55
DARCOM (1)	1-128	29-57
TRADOC (2)	7	29-75
OS Maj Cored (4)	7-15	29-79
TECOM (2)	7-16	29-85
USACC (4)	7-45	29-86
MSW (1)	7-46	29-87
Armies (2)	7-56	29-105
Corps (2)	7-100	25-109
Svc colleges (1)	11-117	29-134
USASIGS (5)	11-302	29-136
USAADS (2)	11-500) (AA-AC)	29-245
USAFAS (2)	17	29-247
USAARMS (2)	17-15	31-105
USAIS (2)	17-16	37
USAES (2)	17-51	27-100
USAICS (3)	17-55	44-235
MAAG. (1)	17-56	44-236
USARMIS (1)	17-96	44-255
USAERDAA (1)	17-96	44-256
USAERDAW (1)	17-100	44-547
Fort Gillen (10)	17-105	55-99
Fort Gordon (10)	17-106	55-157
Fort Huachuca (10)	29-1	55-405
Fort Carson (5)	29-11	55-406
Ft Monmouth (HISA) (26)	29-15	55-407
Ft Richardson (CERCOM) (2)	29-16	55-457
Army Dep (1) except	29-17	55-458
LBAD (14)	29-21	57
SAAD (30)	29-25	57-100
TOAD (14)	29-26	67-4
SHAD (3)	29-27	77-100
USA Dep (1)	29-35	
Sig Sec USA Dep (1)	29-36	

NG: State AG (3); Units- Same as active Army except allowance is one copy per unit
USAR: None

For explanation of abbreviation used, see AR 310-50.

CHANGE }
No. 1 }

HEADQUARTERS
DEPARTMENT OF THE ARMY
WASHINGTON, DC 18 August 1975

**Organizational, Direct Support General
Support and Depot Maintenance Repair Parts
and Special Tools Lists
TEST SETS, ELECTRICAL POWER
AN/UPM-93A, AN/UPM-93B, AN/UPM-93C,
AN/UPM-93D, AN/UPM-100, AND AN/UPM-100A**

TM 11-6625-303-25P, 12 October 1971, is changed as follows:

Title of manual is changed as shown above.

Page 1-2. Paragraph 1-3b is superseded as follows:

b. Federal Stock Number. This column indicates the Federal stock number assigned to the item.

NOTE

For requisitioning purposes, the Federal stock number must be converted to the National stock number by adding "-00-" after the Federal stock classification (FSC) code (first four digits). For example, FSN 6625-553-0142 converts to NSN 6625-00-553-0142

Page 1-3, paragraph 1-7. Line 5, after Publications add "and Blank Forms."

"Commanding General" is changed to read "Commander."

Line 7. "ME-NMP-EM" is changed to read "MA-Q"

Page 5-1. Section VI, VII, and IX are added after section V.

**SECTION VI
INTRODUCTION**

7-1. Scope

This manual lists repair parts required for the performance of organizational, direct support, and general support of the AN/UPM-93D and AN/UPM-100A.

7-2. General

This Repair Parts lists is divided into the following sections:

a. Section VII.. Repair Parts List. A list of repair parts authorized for use in the performance of maintenance. The list includes parts which must be removed for replacement of the authorized parts. Parts lists are composed of functional groups in ascending numerical sequence, with the parts in each group listed in figure and item number sequence.

b. Section VZZZ. Special Tools List. Not applicable.

c. *Section IX, National Stock Number and Part Number Index.* A list, in ascending numerical sequence, of all National stock numbers appearing in the listings, followed by a list, in alpha-numeric sequence, of all part numbers appearing in the listing. National stock numbers and part numbers are cross-reference to each illustration figure and item number appearance.

7-3. Explanation of columns

The following provides an explanation of columns found in the tabular listings:

a. *Illustration.* This column is divided as follows:

(1) *Figure number.* Indicates the figure number of the illustration in which the item is shown.

(2) *Item Number.* The number used to identify each item called out in the illustration.

b. *Source, Maintenance, and Recoverability Codes (SMR).*

(1) *Source code.* Source codes are assigned to support items to indicate the manner of acquiring support items for maintenance, repair, or overhaul of end items. Source codes are entered in the first and second positions of the Uniform SMR Code format as follows:

<i>Code</i>	<i>Definition</i>
PA —	Item procured and stocked for anticipated or known usage.
XD—	A support item that is not stocked when required, item will be procured through normal supply channels.

NOTE

Cannibalization or salvage may be used as a source of supply for any items source coded above except those coded XA, XD, and aircraft support items as restricted by AR 700-42

(2) *Maintenance code.* Maintenance codes are assigned to indicate the levels of maintenance authorized to USE and REPAIR support items. The Uniform SMR Code format is as follows:

(a) The maintenance code entered in the third position will indicate the lowest maintenance level authorized to remove, replace, and use the support item. The maintenance code entered in the third position will indicate one of the following levels of maintenance

<i>code</i>	<i>Application/Explanation</i>
O—	Support item is removed, replaced, and used at the organizational level.
H—	Support item is removed, replaced, used at the general support level.

(b) The maintenance code entered in the fourth position indicates whether the item is to be repaired and identifies the lowest maintenance level

with the capability to perform complete repair (i.e., all authorized maintenance functions). This position will contain one of the following maintenance codes:

<i>code</i>	<i>Definition</i>
H—	The lowest maintenance level capable of complete repair of the support item is the general support level.
Z—	Nonreparable. No repair authorized.

(3) *Recoverability code.* Recoverability codes are assigned to support items to indicate the disposition action on unserviceable items. The recoverability code is entered in the fifth position of the Uniform SMR Code format as follows:

<i>Recoverability codes</i>	<i>Definition</i>
Z—	Nonreparable item. When unserviceable, condemn and dispose at the level indicated in position 3.
H—	Reparable item. When uneconomically reparable, condemn and dispose at the general support level.

c. *National Stock Number.* Indicates the National stock number assigned to the item and will be used for requisitioning purposes.

d. *Part Number.* Indicates the primary number used by the manufacturer (individual, company, firm, corporation, or government activity), which controls the design and characteristics of the item by means of its engineering drawings, specifications standards, and inspection requirements, to identify an item or range of items.

NOTE

When a stock-numbered item is requisitioned, the repair part received may have a different part number than the part being replaced.

e. *Federal Supply Code for Manufacturer (FSCM).* The FSCM is a 5-digit numeric code listed in SB 708-42 which is used to identify the manufacturer, distributor, or government agency, etc.

f. *Description.* Indicates the Federal item name and, if required, a minimum description to identify the item. Items that are included in kits and sets are listed below the name of the kit or set with the quantity of each item in the kit or set indicated in the quantity incorporated in unit column. When the part to be used differs between serial numbers of the same model, the effective serial numbers are shown as the last line of the description.

g. *Unit of Measure (U/M).* Indicates the standard of the basis quantity of the listed item as used in performing the actual maintenance function. This measure is expressed by a two-character alphabeti-

cal abbreviation (e.g., ea, in, pr, etc.). When the unit of measure differs from the unit of issue, the lowest unit of issue that will satisfy the required units of measure will be requisitioned.

h. Quantity Incorporated in Unit. Indicates the quantity of the item used in the breakout shown on the illustration figure, which is prepared for a functional group, subfunctional group, or an assembly.

7-4. Special Information

a. Usable on codes are shown in the description column. Uncoded items are applicable to all models. Identification of the usable on codes used in this publication are:

code	Used on
9AA	AN/UPM-93D
9AB	AN/UPM-100A

b. The following publications pertain to the AN/UPM-93D and AN/UPM-100A and their components:

TM 11-6625-303-12	Operator's and Organizational Maintenance Manual: Electrical Power Test Set AN/UPM-93A, AN/UPM-93B, AN/UPM-93C, and AN/UPM-100.
TM 11-6625-303-35	Direct Support and General Support Maintenance Manual: Electrical Power Test Sets AN/UPM-93B, AN/UPM-93C, and AN/UPM-100.

7-5. How to Locate Repair Parts

a. When National stock number or part number is unknown:

(1) *First.* Using the table of contents, determine the functional group within which the repair part belongs. This is necessary since illustrations are prepared for functional groups and listings are divided into the same group.

(2) *Second.* Find the illustration covering the functional group to which the repair part belongs.

(3) *Third.* Identify the repair part on the illustration and note the illustration figure and item number of the repair part.

(4) *Fourth.* Using the Repair Parts Listing, find the figure and item number noted on the illustration.

b. When National stock number or part number is known:

(1) *First.* Using the Index of National Stock Numbers and Part Numbers, find the pertinent National stock number or part number. This index is in ascending NSN sequence followed by a list of part numbers in ascending alphanumeric sequence, cross-referenced to the illustration figure number and item number.

(2) *Second.* After finding the figure and item number, locate the figure and item number in the repair parts list.

7-6. Abbreviations

Not applicable.

7-7. Recommendation for Maintenance Publications Improvements

You can help to improve this manual by calling attention to errors and by recommending improvements. Your letter or DA Form 2028 (Recommended Changes to Publications and Blank Forms) should be mailed directly to Commander, US Army Electronic Command, ATTN: AMSEL-MA-Q, Fort Monmouth, New Jersey 07703.

SECTION VII

(1) ILLUSTRATION (A) FIG NO.	(2) (B) ITEM NO.	(3) SMR CODE	(4) NATIONAL STOCK NUMBER	(5) PART NUMBER	(6) FSCM DESCRIPTION	(7) USABLE ON CODE	(8) UNIT OF MEAS IN UNIT
GROUP 00: TESTS SETS, ELECTRICAL POWER AN/UPM-93D AND AN/UPM-100A							
6	1	PAHZZ		SM-B-146834	80063 GASKET		EA 1
6	2	PAHZZ	5310-00-187-2398	AN960PD6L	88044 WASHER, FLAT		EA 4
6	3	XDHZZ		SM-B-189405	80063 CLIP, FUSE		EA 4
6	4	XDHZZ		SM-B-84162	80063 CLIP ASSEMBLY		EA 1
6	5	XDHZZ		SM-B-84165	80063 CLIP ASSEMBLY		EA 1
6	6	PAOZZ	5935-00-581-3170	SM-B-174275	80063 CONNECTOR ADAPTER		EA 1
6	7	PAHZZ	5940-00-702-5656	SM-B-174274	80063 CLIP		EA 2
6	8	XDHZZ		SM-C-146832	80063 PLATE, MOUNTING		EA 1
6	9	XDHZZ		SM-B-146833	80063 RIVET, SOLID		EA 8
6	10	XDHZZ		SM-C-189401	80063 CASE, TOP		EA 1
6	11	XDHZZ		SM-B-174197	80063 PLATE, IDENTIFICATION		EA 1
6	12	XDHZZ		SM-C-146837	80063 CASE, BOTTOM		EA 1
6	13	XDHZZ		SM-D-D189406	80063 PANEL ASSEMBLY		EA 1
7	1	PAHHH	6625-00-643-8544	SM-B-174265	80063 LEAD, TEST		EA 1
7	2	PAHZZ	6145-00-164-6952	MIL-W-13169	81349 WIRE, ELECTRICAL		EA 2
7	3	PAHHH	6625-00-643-8546	SC-C-82761	80063 PROD, TEST, MX-1910/U		EA 2
7	4	XDHZZ		SC-C-76302-3	80063 INSULATOR, SLEEVE		EA 2
7	5	XDHZZ		SC-B-23287	8063 WASHER, FLAT		EA 2
7	6	PAHZZ	6625-00-669-0244	SC-B-76301	80063 TIP, TEST PROD		EA 2
7	7	PAHZZ	6115-00-745-7591	4059-125	81825 FREQUENCY METER	9AA	EA 1
7	7	PAHZZ	6625-00-682-4666	6815-125	6339 FREQUENCY METER	9AB	EA 1
7	8	PAHZ	6625-00-935-1444	SM-B-204605	80063 VOLTMETER		EA 1
7	9	PAHZZ		MS35249-21	96906 SCREW, MACHINE		EA 2
7	10	PAHZZ		SM-D-189406-7	80063 BOOT, RUBBER		EA 1
7	11	PAHZZ		SM-C-189403	80063 PANEL, FRONT		EA 1
7	12	PAHZZ		MS-35200-13	96906 SCREW, MACHINE		EA 4
7	13	PAHZZ	5930-00-660-3950	MS24524-30	96906 SWITCH, TOGGLE		EA 1
7	14	PAHZZ	5905-00-279-2527	RC42FG223J	81349 RESISTOR		EA 2
7	15	PAHZZ	5940-00-329-5409	863	83330 TERMINAL BOARD		EA 1
7	16	PAHZZ	5310-00-782-1349	AN960C4	88044 WASHER		EA 2
7	17	PAHZZ	5310-00-934-9748	AN340C4	8804 NUT		EA 2
7	18	PAHZZ	5905-00-249-4210	RC42FG123J	81349 RESISITOR		EA 1
7	19	PAHZZ		849	83330 TERMINAL BOARD		EA 1
7	20	PAHZZ		SR3L	28520 STRAIN RELIEF		EA 1

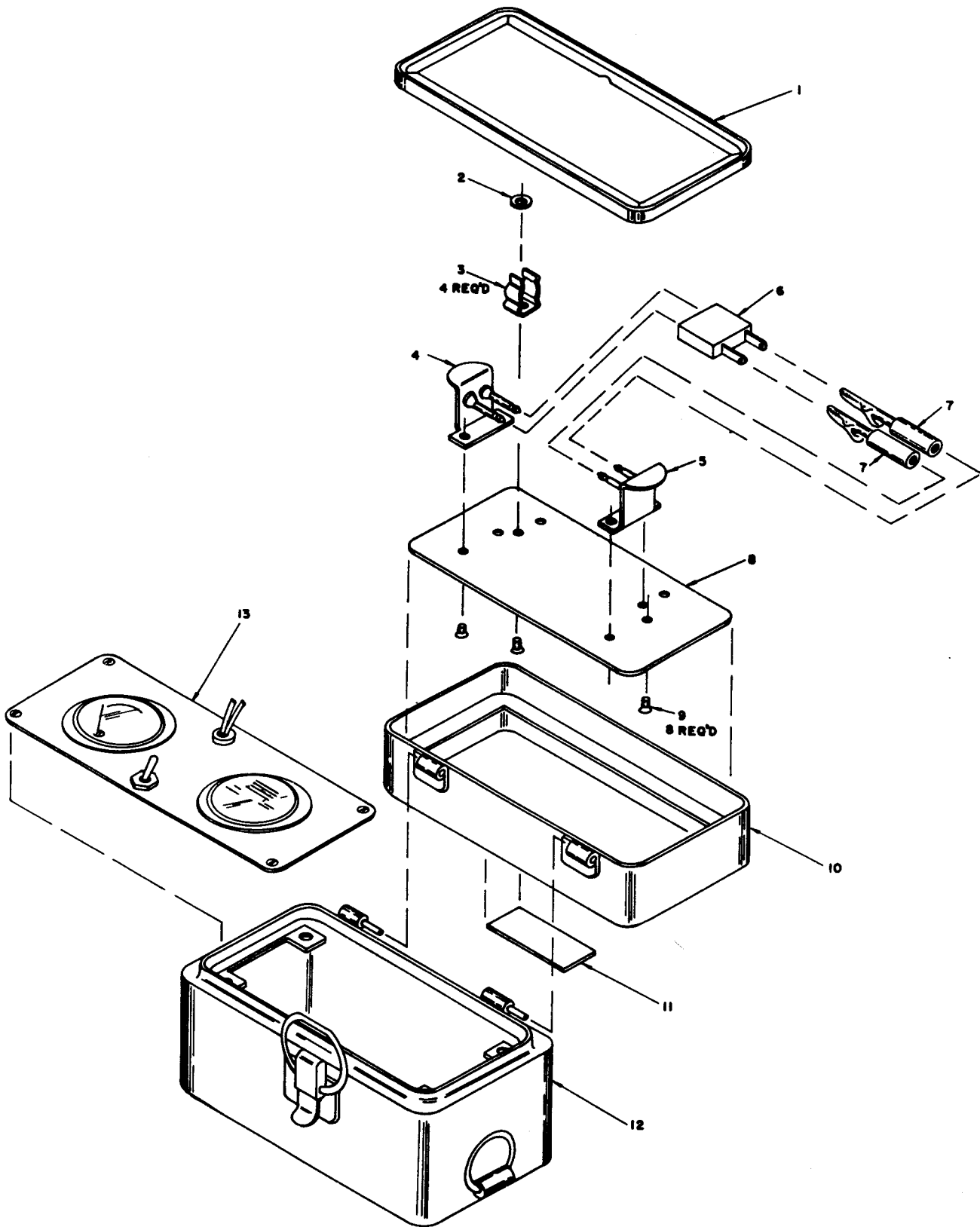

EL6625-303-24P-2

Figure 6. Case, exploded view.

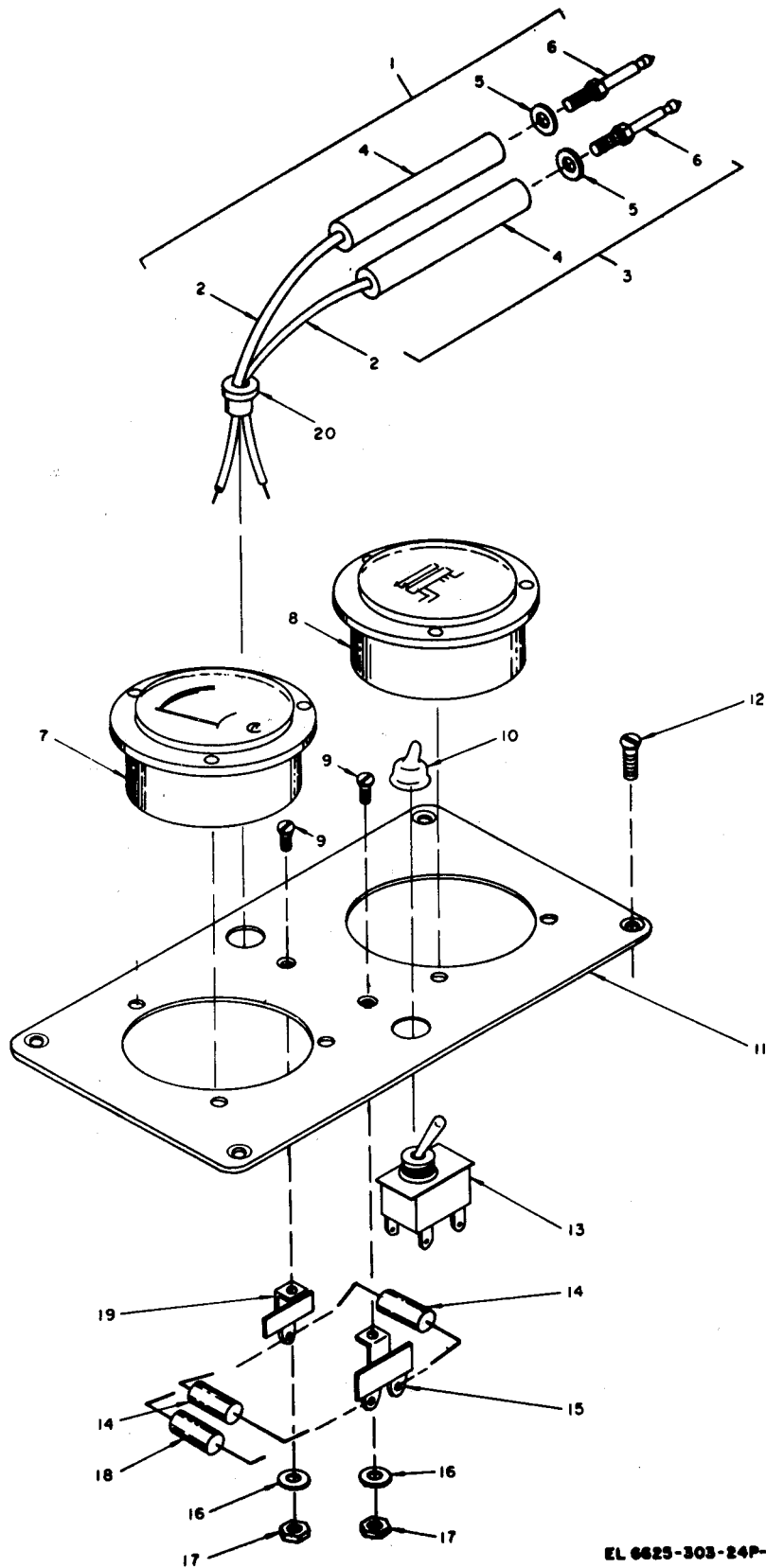

EL 6625-303-24P-1

Figure 7. Front panel, exploded view.

SECTION IX NATIONAL STOCK NUMBER AND PART NUMBER INDEX

SOCK NUMBER	FIG. NO.	ITEM NO.	STOCK NUMBER	FIG. NO.	ITEM NO.
5310-00-187-2398	6	2	5940-00-702-5656	6	7
5310-00-782-1349	7	16	6115-00-745-7591	7	7
5310-00-934-9748	7	17	6145-00-164-6952	7	2
5905-00-249-4210	7	18	6625-00-643-8544	7	1
5905-00-279-2527	7	14	6625-00-643-8546	7	3
5930-00-660-3950	7	13	6625-00-669-0244	7	6
5935-00-581-3171	6	6	6625-00-682-4666	7	7
5940-00-329-5409	7	15	6625-00-935-1444	7	8

PART NUMBER	FSCM	FIG. NO.	ITEM NO.	PART NUMBER	FSCM	FIG. NO.	ITEM NO.
MS-35200-13	96906	7	12	SM-B-84165	80063	6	5
MS35249-21	96906	7	9	SM-C-146832	80063	6	8
SC-C-23287	80063	7	5	SM-C-146837	80063	6	12
SC-C-76302-3	80063	7	4	SM-C--189401	80063	6	10
SM-B-146833	80063	6	9	SM-C-189403	80063	7	11
SM-B-146834	80063	6	1	SM-D-189406	80063	6	13
SM-B-174197	80063	6	11	SM-D-189406-7	80063	7	10
SM-B-189405	80063	6	3	SR3L	28520	7	20
SM-B-84162	80063	6	4	849	83330	7	19

By Order of the Secretary of the Army

FRED C. WEYAND
General, United States Army
Chief of Staff

Official:

VERNE L. BOWERS
Major General, United States Army
The Adjutant General

DISTRIBUTION

ActiveArmy:

USASA (2)	Sig Dep (2)	29-26
Dir of Trans(1)	ATS (1)	29-27
COE (1)	MAAG(1)	29-35
TSG(1)	WRAMC (1)	29-36
USAARENBD (1)	USAATC (2)	29-37
USAAVNTBD (2)	USARMIS (1)	29-41
AMC (1)	USAERDAA (1)	29-51
MICOM (2).	USAERDAW (1)	29-55
TECOM (2)	Sig FLDMS (1)	29-57
TRADOC (2)	Units org under fol TOE: — 1 ea.	29-75
ARADCOM (2)	1-128	29-79
ARADCOM Rgn (2)	7	28-85
OS Maj Comd (4)	7-15	29-86
LOGCOMD (3)	7-16	29-87
MDW(1)	7-45	29-105
Armies (2)	7-46	29-109
Corps (2)	7-58	29-134
USMC (4)	7-100	29-136
HISA (Ft Monmouth) (43)	11-117	29-245
Ft Gillem (10)	11-302	29-247
Ft Gordon (10)	11-500(AA-AC)	31-105
Ft Huachuca (10)	17	37
Ft Carson(5)	17-15	37-100
Ft Richardson (ECOM Ofc) (2)	17-16	44-235
WSMR (1)	17-51	44-236
Svc colleges (1)	17-55	44-255
USASESS (6)	17-56	44-256
USAINTCS (3)	17-95	44-547
USAADS (2)	17-96	55-99
USAFAS(2)	17-100	55-157
USAARMS (2)	17-105	55-405
USAIS(2)	17-106	55-406
USAES (2)	29-1	55-407
AD(l) except	29-11	55-457
SAAD(30)	29.15	55-458
LBAD(14)	29-16	57
ToAD (14)	29-17	57-100
USA Dep(2)	29-21	67-4
Sig Sec USA Dep(2)	29-25	77-100

ARNG: State AG (3); Units - Same as Active Army.

USAR: None.

For explanation of abbreviations used, see AR 310-50.

SECTION I

INTRODUCTION

1-1. Scope

This manual lists repair parts required for the performance of organizational, general support, and depot maintenance of the AN/UPM-93A, AN/UPM-93B, AN/UPM-93C, and AN/UPM-100. No parts authorized for stockage at direct support level.

NOTE

No special tools, test, and support equipment are required.

1-2. General

This repair parts list is divided into the following sections:

a. Repair Parts for Organizational Maintenance—Section II. A list of repair parts authorized for the performance of maintenance at the organizational level,

b. Repair Parts for Direct Support, General Support, and Depot Maintenance—Section III. A list of repair parts authorized for the performance of maintenance at the general support and depot level.

c. Index—Federal Stock Number Cross-Reference to Figure and Item Number or Reference Designation—Section IV. A list of Federal stock numbers in ascending numerical sequence, cross-reference to the illustration figure number and reference designation.

d. Index—Reference Designation Cross-Reference to Page Number—Section V. A list of reference designations cross-referenced to page numbers.

1-3. Explanation of Columns

The following provides an explanation of columns in the tabular lists:

a. Source, Maintenance, and Recoverability Codes (SMR).

(1) Source code indicates the selection status and source for the listed item, Source codes are-

Code	Explanation
P	—Repair parts which are stocked in or supplied from the GSA/DSA, or Army supply system, and authorized for use at indicated maintenance categories,
P2	—Repair parts which are procured and stocked for insurance purposes because the combat or military essentiality of the end item dictates that a minimum quantity be available in the supply system.

Code	Explanation
P9	—Assigned to items which are NSA design controlled: unique repair parts, special tools, test, measuring and diagnostic equipment, which are stocked and supplied by the Army COMSEC logistic system, and which are not subject to the provisions of AR 380-41.
P10	—Assigned to items which are NSA design controlled: special tools, test, measuring and diagnostic equipment for COMSEC support, which are accountable under the provisions of AR 380-41, and which are stocked and supplied by the Army COMSEC logistic system.
M	—Repair parts which are not procured or stocked, but are to be manufactured in indicated maintenance levels.
A	—Assemblies which are not procured or stocked as such, but are made up of two or more units. Such component units carry individual stock numbers and descriptions, are procured and stocked separately, and can be assembled to form the required assembly at indicated maintenance categories.
X	—Parts and assemblies which are not procured, or stocked and the mortality of which normally is below that of the applicable end item or component. The failure of such part or assembly should result in retirement of the end item from the supply system.
X1	—Repair parts which are not procured or stocked. The requirement for such items will be filled by use of the next higher assembly or component.
X2	—Repair parts which are not stocked. The indicated maintenance category requiring such repair parts will attempt to obtain same through cannibalization. Where such repair parts are not obtainable through cannibalization, requirements will be requisitioned, with accompanying justification, through normal supply channels.
G	—Major assemblies that are procured with PEMA funds for initial issue only as exchange assemblies at DSU and GSU level. These assemblies will not be stocked above DS and GS level or returned to depot supply level.
(2)	Maintenance code indicates the lowest cate-

gory of maintenance authorized to install the listed item. The maintenance level codes are-

<i>Code</i>	<i>Explanation</i>
C	Operator/crew
O	Organizational maintenance
F	Direct support maintenance
H	General support maintenance
D	Depot maintenance

(3) Recoverability code indicates whether un-serviceable items should be returned for recovery or salvage. Items not coded are expendable. Recoverability codes are-

<i>Code</i>	<i>Explanation</i>
R	—Repair parts and assemblies that are economically repairable at DSU and GSU activities and are normally furnished by supply on an exchange basis.
S	—Repair parts and assemblies which are economically repairable at DSU and GSU activities and which normally are furnished by supply on an exchange basis. When items are determined by GSU to be uneconomically repairable, they will be evacuated to a depot for evaluation and analysis before final disposition.
T	—High dollar value recoverable repair parts which are subject to special handling and are issued on an exchange basis. Such repair parts normally are repaired or overhauled at depot maintenance activities,
U	—Repair parts specifically selected for salvage by reclamation units because of precious metal content, critical materials, or high dollar value reusable casings or castings,

b. Federal Stock Number. Indicates the Federal stock number assigned to the item and will be used for requisitioning purposes.

c. Description. Indicates the Federal item name and any additional description of the item required. The index number has been included as part of the description to aid in the location of "same as" items. A part number, or other reference number, is followed by the applicable five-digit Federal supply code for manufacturers in parentheses,

d. Unit of Measure (U/M). A two-character alphabetic abbreviation indicating the amount or quantity of the item upon which the allowances are based; e.g., ft, ea, pr, etc.

e. Quantity Incorporated in Unit. Indicates the quantity of the item used in AN/UPM-93A, AN/UPM-93B, AN/UPM-93C, and AN/UPM-100,

f. 15-Day Organizational Maintenance Allowances.

(1) The allowance columns are divided into

four subcolumns. Items authorized for use as required, but not for initial stockage, are identified with an asterisk in the allowance column.

(2) The quantitative allowance for organizational level of maintenance represents one initial prescribed load for a 15-day period for the number of equipments supported. Units and organizations authorized additional prescribed loads will multiply the number of prescribed loads authorized by the quantity of repair parts reflected in the appropriate density column to obtain the total quantity of repair parts authorized.

(3) Organizational units providing maintenance for more than 100 of these equipments shall determine the total quantity of parts required by converting the equipment quantity to a decimal factor by placing a decimal point before the next to last digit of the number to indicate hundredths, and multiplying the decimal factor by the parts quantity authorized in the 51-100 allowance column. Example, authorized allowance for 51-100 equipments is 12; for 140 equipments multiply 12 by 1.40 or 16.80 rounded off to 17 parts required.

g. 30-Day DS/GS Maintenance Allowances

NOTE

Allowances in GS Column are for GS maintenance only.

(1) The allowance columns are divided into three subcolumns. Indicated in each subcolumn is the total quantity of items authorized for the number of equipments supported. Items authorized for use as required, but not for initial stockage, are identified with an asterisk in the allowance column

(2) The quantitative allowances for GS level of maintenance will represent initial stockage for a 30-day period for the number of equipments supported.

(3) Determination of the total quantity of parts required for maintenance of more than 100 of these equipments can be accomplished by converting the equipment quantity to a decimal factor by placing a decimal point before the next to last digit of the number to indicate hundredths, and multiplying the decimal factor by the parts quantity authorized in the 51-100 allowance column. Example, authorized allowance for 51-100 equipments is 40; for 150 equipments multiply 40 by 1.50 or 60 parts required,

h. 1-Year Allowances Per 100 Equipments/Contingency Planning Purposes. Indicates the total quantity required for distribution and contingency planning purposes. The range of items indicates total quantities of all authorized items required to provide for adequate support of 100 equipments for 1 year.

i. Depot Maintenance Allowance Per 100 Equipments. Indicates the total quantity authorized for depot maintenance of 100 equipments. Items authorized for use as required, but not for initial stockage, are identified with an asterisk in the allowance column.

j. Illustrations.

(1) *Figure number.* Indicates the figure number of the illustration in which the item is shown.

(2) *Item number or reference designation.* Indicates the reference designation used to identify the item in the illustration.

1-4. Special Information

a. Identification of the usable on codes of this publication are-

Code	Used on
1	AN/UPM-93A,B
2	AN/UPM-93C
3	AN/UPM-100

b. Repair parts mortality is computed from failure rates derived from experience factors with the individual parts in a variety of equipments. Variations in the specific application and periods of use of electronics equipment, the fragility of electronic piece parts, plus intangible material and quality factors intrinsic to the manufacture of electronic parts, do not permit mortality to be based on hours of end item use. However, long periods of continuous use under adverse conditions are likely to increase repair parts mortality,

c. The following publications pertain to the AN/UPM-93A, AN/UPM-93B, AN/UPM-93C, and AN/UPM-100 and their components:

TM 11-6625-303-12—Operator and Organizational Maintenance Manual: Electrical Power Test Sets AN/UPM-93A, AN/UPM-93B, AN/UPM-93C, and AN/UPM-100.

TM 11-6625-303-35-DS, GS, and Depot Maintenance Manual: Electrical Power Test Sets AN/UPM-93A, AN/UPM-93B, AN/UPM-93C, and AN/UPM-100.

1-5. Location of Repair Parts

a. This manual contains two cross-reference in-

dexes (sec. IV and sec. V) to be used to locate a repair part when either the Federal stock number or reference designation is known. The first column in each index is prepared in numerical or alpha-numeric sequence in ascending order.

b. When the Federal stock number is known, follow the procedures given in (1) and (2) below.

(1) Refer to the index of Federal stock numbers (sec. IV) and locate the Federal stock number. The FSN is cross-referenced to the applicable figure and reference designation.

(2) When the reference designation is determined, refer to the reference designation index (sec. V). The reference designations are listed in alpha-numeric ascending order and are cross-referenced to the page number on which they appear in the repair parts list (sec. III). Refer to the page number noted in the index and locate the reference designation in the repair parts list (col. 10b, Repair Parts for Direct Support, General Support, and Depot Maintenance).

c. When the reference designation is known, follow the procedures given in *b* (2) above.

d. When neither the FSN nor reference designation is known, identify the part in the illustration and follow directions given in *c* above, or scrutinize column 3 of the repair parts lists (sec. II and sec. III) .

1-6. Federal Supply Codes for Manufacturers

Code	Manufacturer's name
57771	Simpson Edwin B Co Inc
66150	Winslow Teletronics Inc
75915	Littlefuse Inc
80063	Army Electronics Command
81349	Military Specifications
83777	LTV Electrosystems Inc Memcor Div
68044	Aeronautical Standards Group
91802	Industrial Devices Inc
96906	Military Standards

1-7. Reporting of Equipment Publication Improvements

The reporting of errors, omissions, and recommendation for improving this publication by the individual user is encouraged. Reports should be submitted on DA Form 2028 (Recommended Changes to Publications) and forwarded direct to Commanding General, US Army Electronics Command, ATTN: AMSEL-ME-NMP-EM, Fort Monmouth, N.J. 07703.

SECTION II REPAIR PARTS FOR ORGANIZATIONAL MAINTENANCE (CONTINUED)

(1) SMR CODE	(2) FEDERAL STOCK NUMBER	(3) DESCRIPTION REFERENCE NUMBER & MFR CODE	USABLE ON CODE	(4) UNIT OF MEAS	(5) QTY INC IN UNIT	(6) 15-DAY ORGANIZATIONAL MAINTENANCE ALW				(7) ILLUSTRATIONS	
						(A)	(B)	(C)	(D)	FIG NO.	(A) (B) OR REFERENCE DESIGNATION
	6625-581-2097	A001 TEST SET, ELECTRICAL POWER AN/UPM-93B (THIS ITEM IS NONEXPENDABLE)	1								
	6625-971-6210	A002 TEST SET, ELECTRICAL POWER, AN/UPM-93C (THIS ITEM IS NONEXPENDABLE)	2								
	6625-542-1290	A003 TEST SET, ELECTRICAL POWER AN/UPM-100 (THIS ITEM IS NONEXPENDABLE)	3								
P-O	5935-581-3170	A004 ADAPTER, CONNECTOR U-175/U	1,2,3	EA	1	*	*	*	*	1	
P-O	5940-702-5256	A010 CLIP ELECTRICAL: 1410D1 (91802)	1,2,3	EA	2	*	*	*	*	1	
P-O	6625-672-9296	A011 COVER, TEST SET CASE: 362-03 (66150)	1,3	EA	1	*	*	*	*	2	
P-O	6625-077-2398	A012 COVER, TEST SET CASE: SM-C-189401 (80063)	2	EA	1	*	*	*	*	1	
G-C-S		A037 TEST SET, ELECTRICAL POWER TS-934A/U	1	EA	1					1	
G-C-S	6625-971-6211	A038 TEST SET, ELECTRICAL POWER TS-934B/U	2	EA	1					1	
G-C-S		A039 TEST SET, ELECTRICAL POWER TS-914/U	3	EA	1					2	

SECTION III. REPAIR PARTS FOR DIRECT SUPPORT, GENERAL SUPPORT, AND DEPOT MAINTENANCE

(1)	(2)	(3)	(4)	(5)	(6)	(7)	(8)	(9)	(10)		
SMR	FEDERAL	DESCRIPTION	UNIT	QTY			1 YR	DEPOT	ILLUSTRATIONS		
CODE	STOCK		OF	INC IN	30-DAY DS MAINT	30-DAY GS MAINT	ALW PER	MAINT	(A) (B)		
	NUMBER		MEAS	UNIT	ALLOWANCE	ALLOWANCE	EQUIP	ALW PER	FIG		
		REFERENCE NUMBER & MFR. CODE	USABLE ON		(A) (B) (C)	(A) (B) (C)	CNTGCTY	100	NO.		
			CODE		1-20 21-50 51-100	1-20 21-50 51-100		EQUIP	OR		
									DESIGNATION		
	6625-581-2097	A001 TEST SET, ELECTRICAL POWER AN/UPM-93A, AN/UPM-93B (THIS ITEM IS NONEXPENDABLE)									
	6625-971-6210	A002 TEST SET, ELECTRICAL POWER AN/UPM-93C (THIS ITEM IS NONEXPENDABLE)									
	6625-542-1290	A003 TEST SET, ELECTRICAL POWER AN/UPM-100 (THIS ITEM IS NONEXPENDABLE)									
P-O	5935-581-3170	A004 ADAPTER, CONNECTOR: U-175/U	1,2,3	EA	1	* *	2	8	5	1	
M-D		A005 BOTTOM ASSEMBLY:	2	EA	1						
A-H		A006 BOX ASSEMBLY: SM-C-146836 -80063 SM-C-146837 (80063)	1,2	EA	1						
P-H	5340-205-5173	A007 CATCH, LUGGAGE: 15840 -14608	1,3	EA	1	* * *	4		2		
P-H	5940-279-7999	A008 CLIP, ELECTRICAL: 104002 -75915	1,2,3	EA	4	* 2	2	16	12	1	
P-H	6625-981-0589	A009 CLIP, ASSEMBLY: SM-B-84165 (80063)	1,2,3	EA	2	* *	2	10	6	1	
P-O	5940-702-5256	A010 CLIP, ELECTRICAL: 1410D1 (91802)	1,2,3	EA	2	* 2	2	13	10	1	
P-O	6625-672-9296	A011 COVER, TEST SET CASE: 362-03 (66150)	1,3	EA	1	* * *	5		3	2	
P-O	6625-077-2398	A012 COVER, TEST SET CASE: SM-C-189401 (80063)	2	EA	1	* * *	5		3	1	
M-D		A013 GASKET: SM-B-146834	2	EA	1						
P-H	6625-542-1293	A014 METER, ELECTRICAL FREQUENCY: 462-5862-00 (66150)	3	EA	1	* * *	2	8	5	5	M1
P-H	6625-844-6631	A015 METER, ELECTRICAL FREQUENCY: SM-D-204602-11 (80063)	1,2	EA	1	* * *	2	8	5	3	M1
X2-H		A016 NUT, PLAIN, HEXAGON: AN340C4 (88044)	2	EA	2						
A-H		A017 PANEL ASSEMBLY SM-D-204602 (80063)	2	EA	1						
P-H	6625-087-7101	A018 PANEL, MOUNTING: SM-C-189403 (80063)	2	EA	1	* * *	5		3		
P-H	6625-6123-6889	A019 PANEL, MOUNTING: 364-01 (66150)	1,3	EA	1	* * *	5		3		
M-D		A020 PLATE, IDENTIFICATION: SM-B-147196 (80063)	2	EA	1						
M-D		A021 PLATE, IDENTIFICATION SM-C-189404 (80063)	2	EA	1						
A-H		A022 PROD ASSEMBLY: SM-B-174265 (80063)	1,2,3	EA	2						
P-H	6625-643-8544	A023 PROD, TEST: MX1910/U	1,2,3	EA	2	* 2	2	13	10	1	
P-H	5905-279-2527	A024 RESISITOR, FIXED, COMPOSITION: RC4GF223J (81349)	1,2	EA	2	* 2	2	13	10	3	R1,R2
P-H	5905-681-5051	A025 RESISITOR, FIXED, WIREWOUND: RW31G103 (83777)	3	EA	2	* 2	2	13	10	5	R3,R4
P-H	5905-192-0651	A026 RESISTOR, FIXED, COMPOSITION: RC42GF203J (81349)	1,2	EA	1	* *	2	8	5	3	R3
P-H		A027 RING, RETAINING: 460-05 -66150	3	EA	2	* * *	5		4		
X2-D		A028: RIVET, TUBULAR: NI26:(57771)	2	EA	4						

SECTION V REPAIR PARTS FOR DIRECT SUPPORT, GENERAL SUPPORT, AND DEPOT MAINTENANCE

(1)	(2)	(3)	(4)	(5)	(6)	(7)	(8)	(9)	(10)						
SMR	FEDERAL	DESCRIPTION	UNIT	QTY	30-DAY DS MAINT			30-DAY GS MAINT			1 YR	DEPOT	ILLUSTRATIONS		
CODE	STOCK		OF	INC IN	(A)	(B)	(C)	(A)	(B)	(C)	ALW PER	MAINT	(A)	(B)	
	NUMBER		MEAS	UNIT	ALLOWANCE	ALLOWANCE	ALLOWANCE	ALLOWANCE	ALLOWANCE	ALLOWANCE	EQUIP	ALW PER	FIG	ITEM NO	
		REFERENCE NUMBER & MFR. CODE	USABLE ON								CNTGCTY	100	NO.	REFEREN	
			CODE		1-20	21-50	51-100	1-20	21-50	51-100	EQUIP			DESIGNA	
X2-D		A029 RIVET, TUBULAR: SAME AS A028	2	EA	4										
X2-H		A030 SCREW, MACHINE: MS35249-21 (96906)	2	EA	2										
X2-H		A031 SCREW, MACHINE: MS35200-13 (96906)	2	EA	4										
P-H		A032 STRAW RELIEF: SM-D-204602-2 (80063)	1,2,3	EA	1			*	*	2	8	5			
P-H	5930-685-9521	A033 SWITCH, TOGGLE: MS35059-30 (96906)	1,2	EA	1			*	*	2	8	5	3	S1	
P-H	5930-660-5588	A034 SWITCH PUSH: 903-00 -66150	3	EA	1			*	*	2	8	5	2	S1	
M-D		A035 TERMINAL BOARD: SM-D-204602-4 (80063)	2	EA	1										
M-D		A036 TERMINAL BOARD: SM-D-204602-3 (80063)	2	EA	1										
G-C-S		A037 TEST SET, ELECTRICAL POWER: TS-934A/U	1	EA	1									1	
G-C-S	6625-971-6211	A038 TEST SET, ELECTRICAL POWER: TS-934B/U	2	EA	1									1	
G-C-S	6625-917-6211	A038 TEST SET, ELECTRICAL POWER: TS-934B/U	2	EA	1									1	
G-C-S		A039 TEST SET, ELECTRICAL POWER: TS-914/U	3	EA	1									2	
P-H	6625-935-1444	A040 VOLTEMETER: SM-B-204605 -80063	1,2	EA	1			*	*	2	8	5	3	M2	
P-H	6625-542-1300	A041 VOLTEMETER: 475-1400 -66150	3	EA	1			*	*	2	8	5	4	M2	
X2-H		A042 WASHER, LOCK AW960C4 (88044)	2	EA	2										
P-H	6625-542-1316	A043 WINDOW, LOCK: 460-04 -66150	1	EA	1			*	*	*	5	3			
P-H	6145-160-5027	A044 WIRE, ELECTRICAL: WB-10/U		EA	1			*	*	8	40	40			

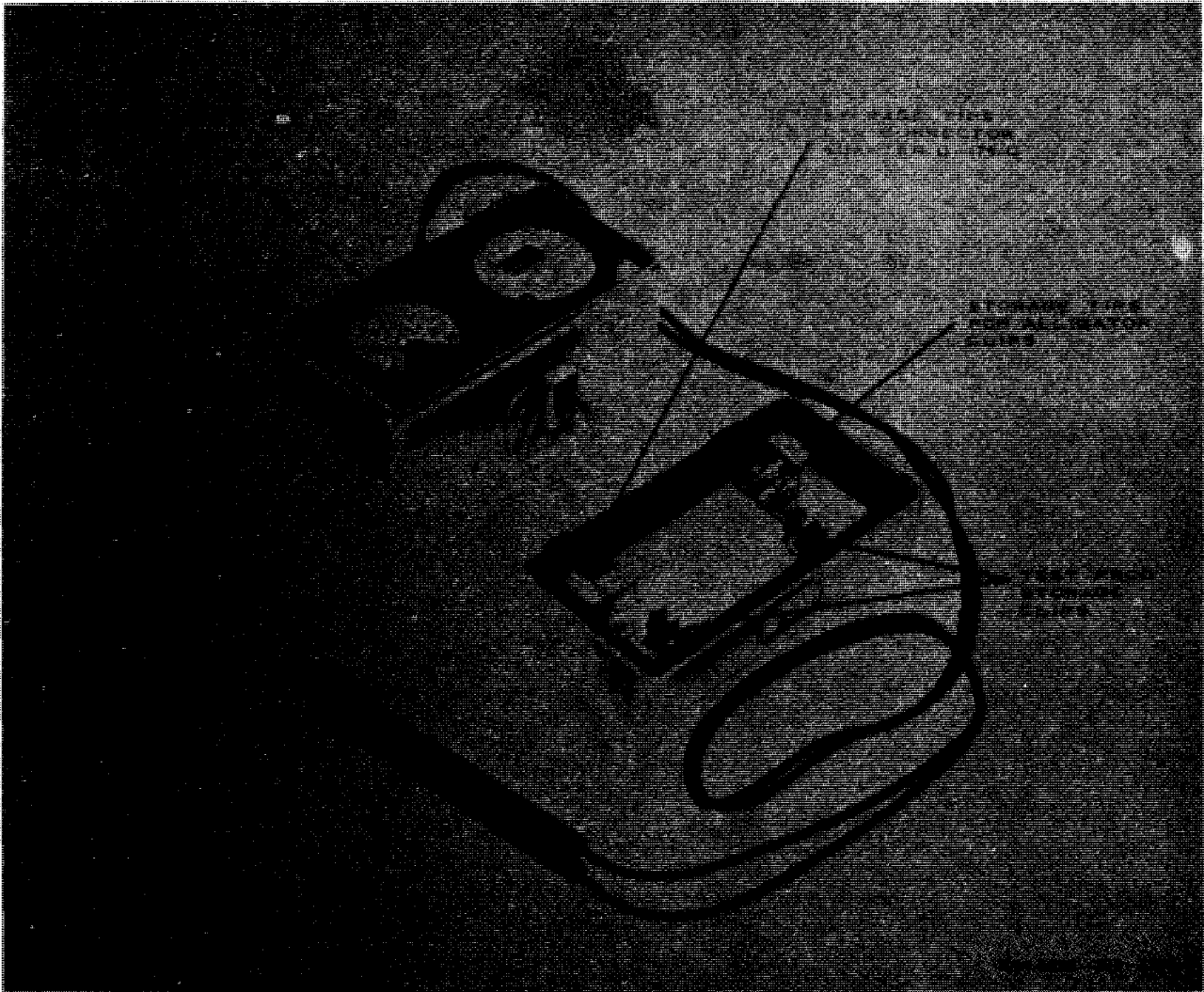

Figure 1. Electrical Power Test Set TS-934A/U; TS-934B/U.

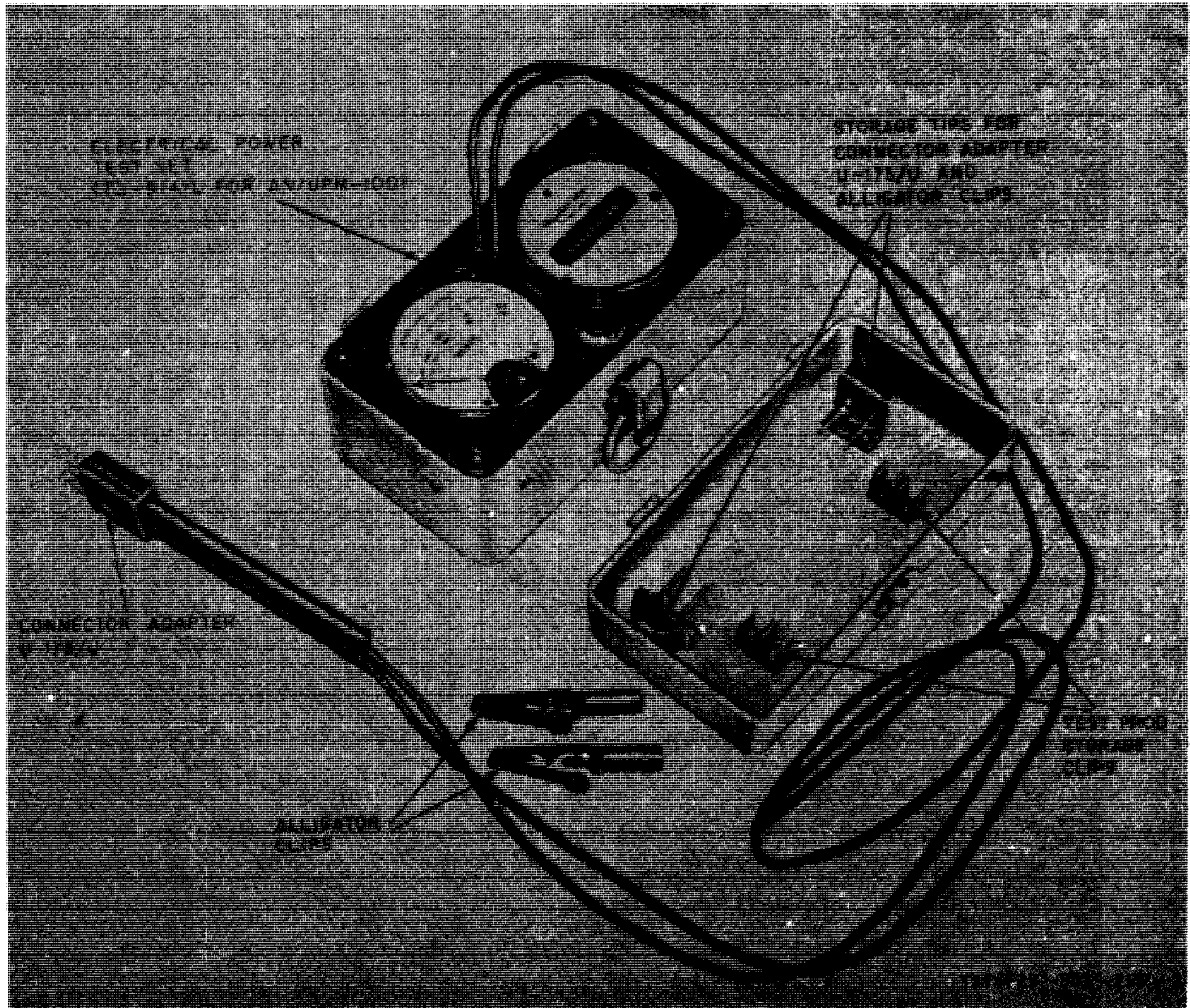

Figure 2. Electrical Power Test Set AN/UPM-100.

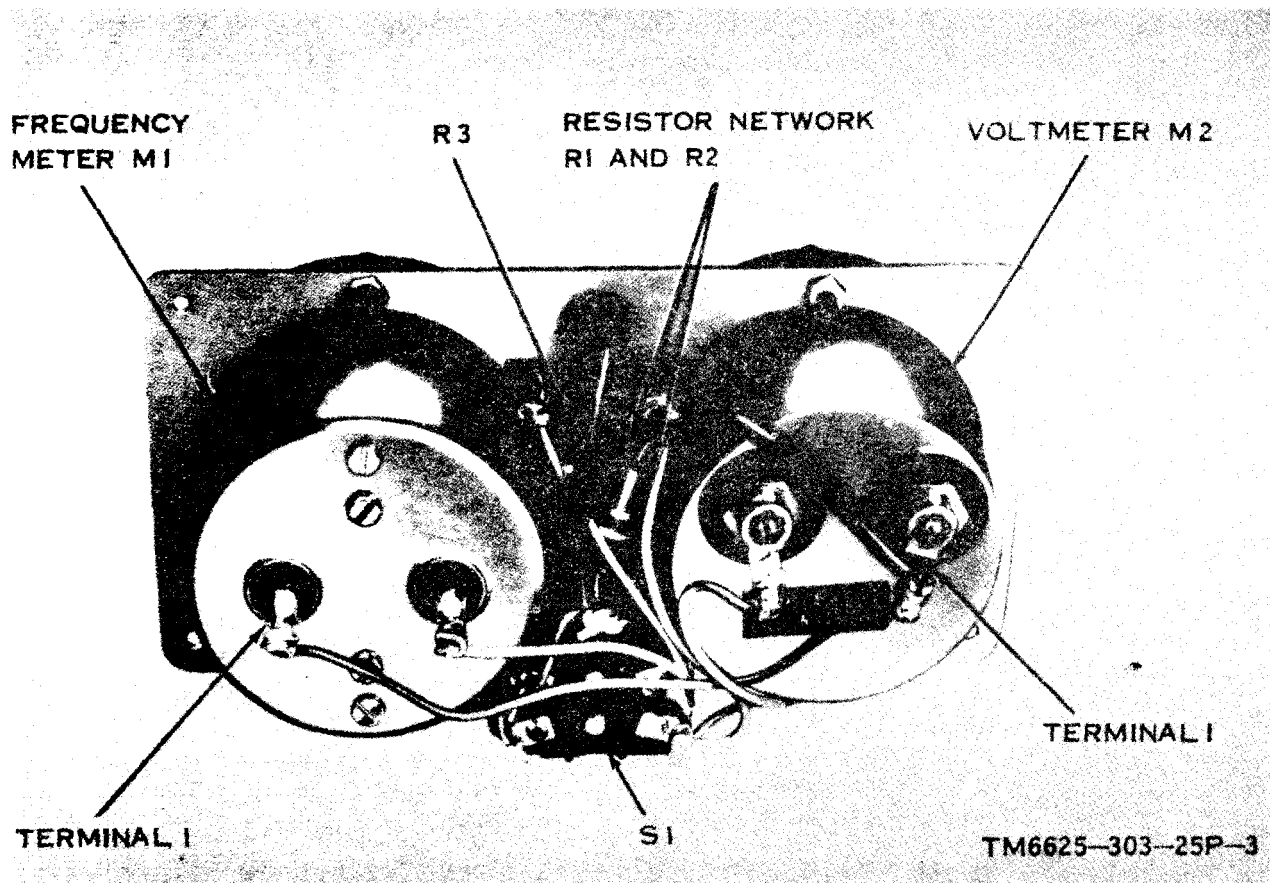

Figure 3. Electrical Power Test Set TS-934A/U; TS-934B/U, interior view.

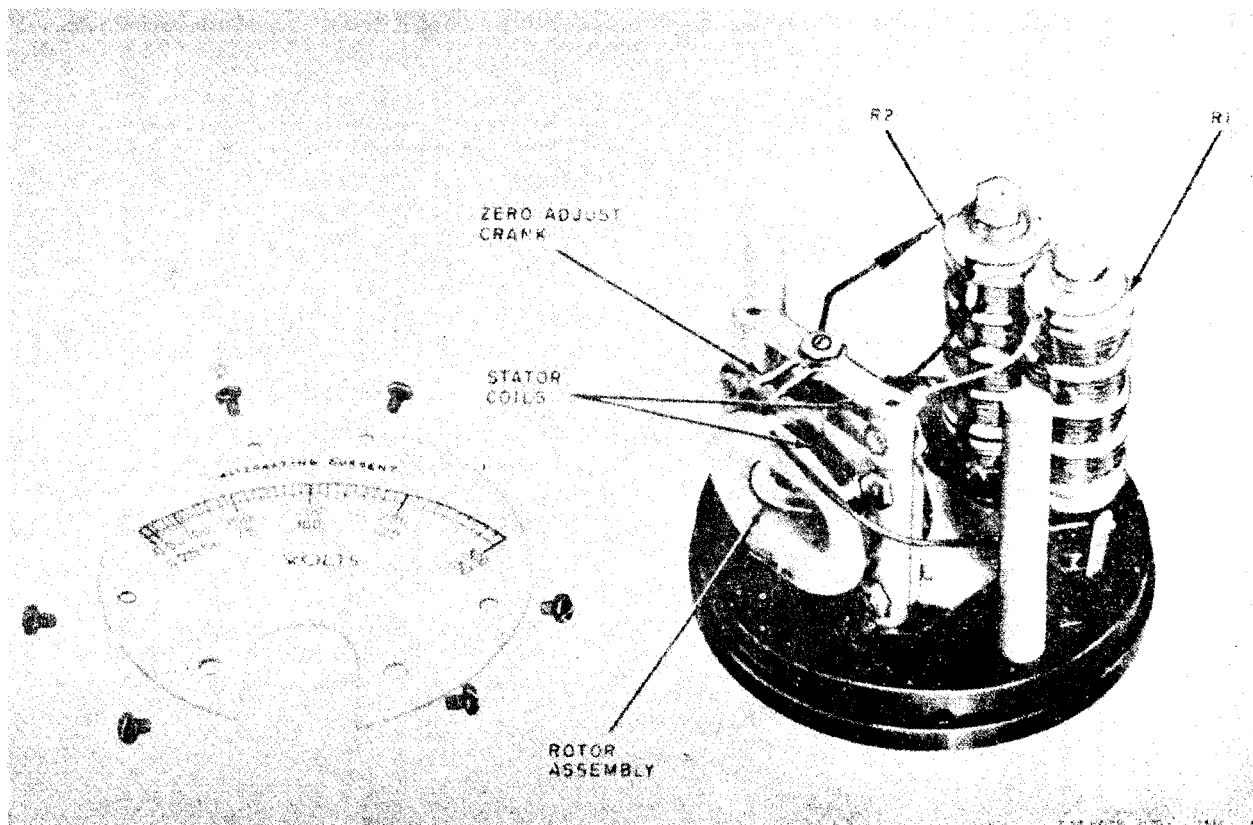

Figure 4. Voltmeter M2, AN/UPM-100, interior view.

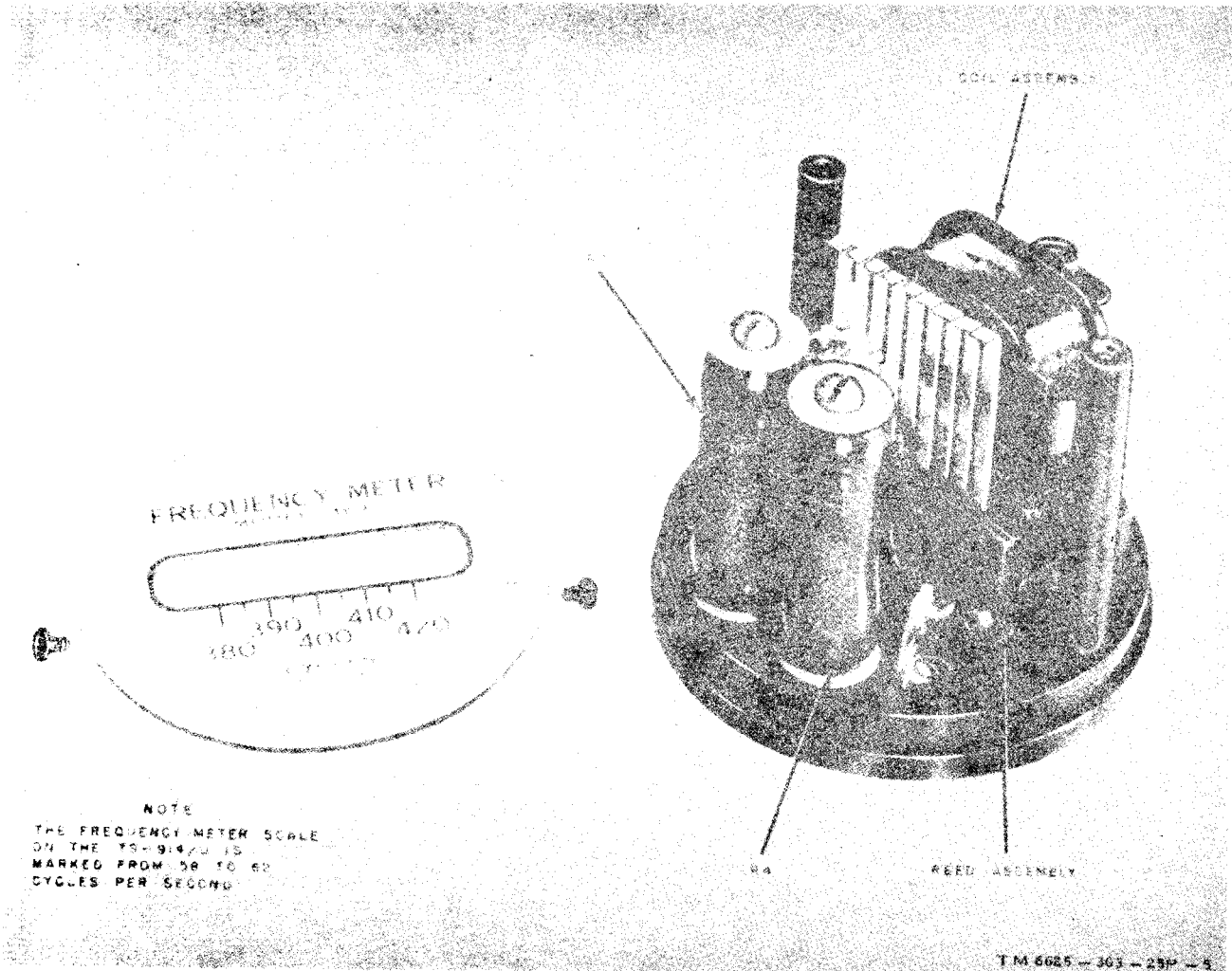

Figure 5. Frequency Meter M1, AN/UPM-100, interior view.

SECTION IV INDEX-FEEDAL NUMBER CROSS REFERENCE
TO FIGURE AND ITEM NUMBER OR REFERENCE DESIGNATION

FEDERAL STOCK NUMBER	FIGURE NUMBER	ITEM NUMBER OR REF. DESIGNATION	FEDERAL STOCK NUMBER	FIGURE NUMBER	ITEM NUMBER OR REF. DESIGNATION
5905-192-0651	3	R3			
5905-279-2527	3	R1			
5905-279-2527	3	R2			
5905-681-5051	5	R3			
5905-681-5051	5	R4			
5930-660-5588	2	S1			
5930-685-9521	3	S1			
6625-542-1293	5	M1			
6625-542-1300	4	M2			
6625-844-6631	3	M1			
6625-935-1444	3	M2			

**SECTION V. INDEX-REFERENCE DESIGNATION
CROSS REFERENCE TO PAGE NUMBER**

REFERENCE DESIGNATION	PAGE NUMBER	REFERENCE DESIGNATION	PAGE NUMBER	REFERENCE DESIGNATION	PAGE NUMBER
M1	3-1				
M2	3-2				
R1	3-1				
R2	3-1				
R3	3-1				
R4	3-1				
S1	3-2				

By Order of the Secretary of the Army:

W. C. WESTMORELAND,
General, United States Army,
Chief of Staff.

Official:

VERNE L. BOWERS,
Major General, United States Army,
The Adjutant General.

Distribution:

Active Army:

USASA (2)
CNGB (1)
ACSC-E (2)
Dir of Trans (1)
COE (1)
TSG (1)
CofSptS (1)
USAARENBD (2)
USAMB (10)
USA4ESWBD (2)
USAAVNTBD (2)
USACDC (2)
USACDC Agcy (1)
USAMC (1)
CONARC (5)
ARADCOM (2)
ARADCOM Rgn (2)
OS Maj Cored (4) except
 USAREUR (10)
 USARYIS (5)
LOGCOMD (5)
USAMICOM (4)
USATECOM (2)
USASTRATCOM (4)
USAESC (70)
MDW (1)
Armies (2)
 corps (2)
 1st Cav Div (3)
 Svc Colleges (2)
 USASESS (5)
 USAADS (2)
 USAFAS (5)
 USAARMS (2)
 USAIS (2)
 USAES (2)
 USAINTS (3)
 WRAMC (1)
 USACDCEC (10)
 USAATC (2)
 Instl (2) except
 Fort Gordon (10)
 Fort Huachuca (10)
 WSMR (3)
 Fort Carson (21)
 Ft Richardson (ECOM Oft) (2)

Army Dep (2)
 LBAD (14)
 SAAD (30)
 TOAD (14)
 LEAD (7)
 NAAD (5)
 SVAD (5)
 ATAD (10)
 Gen Dep (2)
 Sig Sec Gen Dep (5)
 Sig Dep (10)
 Sig FLDMS (2)
 ATS (1)
 USAERDAA (2)
 USAERDAW (5)
 USACRREL (2)
 MAAG (1)
 USARMIS (1)
Units org under fol TOE
 (2 copies each):
 1-128
 1-307
 7
 7-15
 7-16
 7-45
 7-46
 7-58
 7-100
 11-158
 11-500 (AA-AC,
 RL, RD, RV)
 17
 17-15
 17-16
 17-51
 17-55
 17-56
 17-95
 17-96
 17-100
 17-105
 17-106
 29-1
 29-11
 29-15

29-16
29-17
29-21
29-25
29-26
29-27
29-35
29-36
29-37
29-41
29-51
29-55
29-57
29-75
29-79
29-85
29-86
29-87
29-105
29-109
29-134
29-138
29-205
29-206
29-245
29-247

29-500
31-105
33-500
37
37-100
44-233
44-236
44-255
44-256
44-547
45-520
55-50
55-99
55-157
55-405
55-406
55-407
55-457
55-458
55-500
57
57-100
67-2
77-100

NG: None,

USAR: None.

For explanation of abbreviations used, see AR 310-50.

RECOMMENDED CHANGES TO EQUIPMENT TECHNICAL PUBLICATIONS



THEN...JOT DOWN THE DOPE ABOUT IT ON THIS FORM. CAREFULLY TEAR IT OUT, FOLD IT AND DROP IT IN THE MAIL.

SOMETHING WRONG WITH PUBLICATION

FROM: (PRINT YOUR UNIT'S COMPLETE ADDRESS)

DATE SENT

PUBLICATION NUMBER

PUBLICATION DATE

PUBLICATION TITLE

BE EXACT PIN-POINT WHERE IT IS

PAGE NO.

PARA-GRAPH

FIGURE NO.

TABLE NO.

IN THIS SPACE, TELL WHAT IS WRONG AND WHAT SHOULD BE DONE ABOUT IT.

TEAR ALONG PERFORATED LINE

PRINTED NAME, GRADE OR TITLE AND TELEPHONE NUMBER

SIGN HERE

THE METRIC SYSTEM AND EQUIVALENTS

WEIGHT MEASURE

1 Centimeter = 10 Millimeters = 0.01 Meters = 0.3937 Inches
 1 Meter = 100 Centimeters = 1000 Millimeters = 39.37 Inches
 1 Kilometer = 1000 Meters = 0.621 Miles

WEIGHTS

1 Gram = 0.001 Kilograms = 1000 Milligrams = 0.035 Ounces
 1 Kilogram = 1000 Grams = 2.2 lb.
 1 Metric Ton = 1000 Kilograms = 1 Megagram = 1.1 Short Tons

LIQUID MEASURE

1 Milliliter = 0.001 Liters = 0.0338 Fluid Ounces
 1 Liter = 1000 Milliliters = 33.82 Fluid Ounces

SQUARE MEASURE

1 Sq. Centimeter = 100 Sq. Millimeters = 0.155 Sq. Inches
 1 Sq. Meter = 10,000 Sq. Centimeters = 10.76 Sq. Feet
 1 Sq. Kilometer = 1,000,000 Sq. Meters = 0.386 Sq. Miles

CUBIC MEASURE

1 Cu. Centimeter = 1000 Cu. Millimeters = 0.06 Cu. Inches
 1 Cu. Meter = 1,000,000 Cu. Centimeters = 35.31 Cu. Feet

TEMPERATURE

$5/9(^{\circ}\text{F} - 32) = ^{\circ}\text{C}$
 212° Fahrenheit is equivalent to 100° Celsius
 90° Fahrenheit is equivalent to 32.2° Celsius
 32° Fahrenheit is equivalent to 0° Celsius
 $9/5^{\circ}\text{C} + 32 = ^{\circ}\text{F}$

APPROXIMATE CONVERSION FACTORS

TO CHANGE	TO	MULTIPLY BY
Inches	Centimeters	2.540
Feet	Meters	0.305
Yards	Meters	0.914
Miles	Kilometers	1.609
Square Inches	Square Centimeters	6.451
Square Feet	Square Meters	0.093
Square Yards	Square Meters	0.836
Square Miles	Square Kilometers	2.590
Acres	Square Hectometers	0.405
Cubic Feet	Cubic Meters	0.028
Cubic Yards	Cubic Meters	0.765
Fluid Ounces	Milliliters	29.573
its	Liters	0.473
arts	Liters	0.946
allons	Liters	3.785
Ounces	Grams	28.349
Pounds	Kilograms	0.454
Short Tons	Metric Tons	0.907
Pound-Feet	Newton-Meters	1.356
Pounds per Square Inch	Kilopascals	6.895
Miles per Gallon	Kilometers per Liter	0.425
Miles per Hour	Kilometers per Hour	1.609

TO CHANGE	TO	MULTIPLY BY
Centimeters	Inches	0.394
Meters	Feet	3.280
Meters	Yards	1.094
Kilometers	Miles	0.621
Square Centimeters	Square Inches	0.155
Square Meters	Square Feet	10.764
Square Meters	Square Yards	1.196
Square Kilometers	Square Miles	0.386
Square Hectometers	Acres	2.471
Cubic Meters	Cubic Feet	35.315
Cubic Meters	Cubic Yards	1.308
Milliliters	Fluid Ounces	0.034
Liters	Pints	2.113
Liters	Quarts	1.057
ers	Gallons	0.264
ms	Ounces	0.035
ograms	Pounds	2.205
Metric Tons	Short Tons	1.102
Newton-Meters	Pounds-Feet	0.738
Kilopascals	Pounds per Square Inch	0.145
ometers per Liter	Miles per Gallon	2.354
ometers per Hour	Miles per Hour	0.621

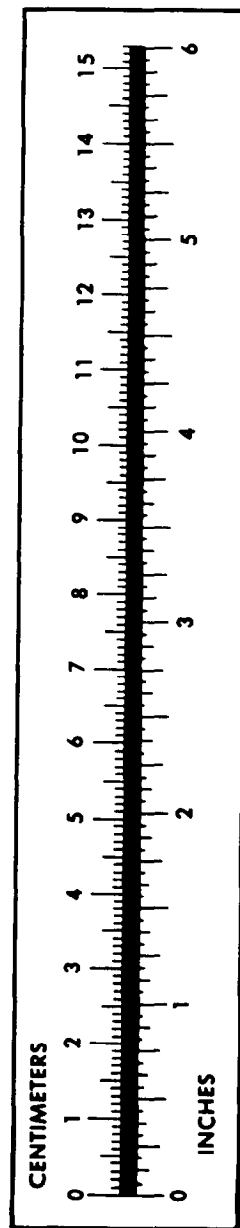

PIN: 017077-002